

# MANHATTAN

LIFESTYLE



**FAP**  
CERAMICHE  
Naturalmente casa.



# MANHATTAN LIFESTYLE





# LA TRADIZIONE NON E' MAI STATA COSI' CONTEMPORANEA

Manhattan è un prodotto unico, colto, versatile. Il formato tradizionale 10x30, il sapore artigianale e la sofisticata gamma di colori minerali raccontano uno stile estremamente contemporaneo.



TRADITION HAS NEVER BEEN SO CONTEMPORARY Manhattan is a unique, sophisticated and versatile product. The traditional size 10x30, the hand-crafted flavour and sophisticated range of mineral colours create an extremely contemporary style.

LA TRADITION N'A JAMAIS ÉTÉ AUSSI CONTEMPORAINE Manhattan est un produit unique, raffiné, éclectique. Son format traditionnel 10x30, son esprit artisanal et sa gamme de couleurs minérales très raffinées racontent un style des plus contemporains.

NOCH NIE WAR DIE TRADITION SO ZEITGEMÄSS Manhattan ist ein einzigartiges, gehobenes und vielseitiges Produkt. Das traditionelle Format 10x30, der Geschmack des Kunsthandwerks und die raffinierte Palette an Mineralfarben zeugen von einem extrem zeitgemäßen Stil.

LA TRADICIÓN NUNCA HABÍA SIDO TAN CONTEMPORÁNEA Manhattan es un producto único, culto y polivalente. El formato tradicional 10x30, el sabor artesanal y la gama sofisticada de colores minerales caracterizan un estilo sumamente contemporáneo.

Традиция никогда не была столь современной Manhattan – это уникальная, остроумная и универсальная коллекция. Традиционный формат 10x30, эффект ремесленного производства и изысканная гамма минеральных красок создают абсолютно современный дизайн.

# JENNIFER & JUSTIN'S LIVING ROOM

/ TRIBECA



**Wall**  
Manhattan White  
**Floor**  
Docks Naturale



# TOTAL / WHITE



# BOB'S KITCHEN

/ MIDTOWN



Wall  
Manhattan Black  
Manhattan White  
Manhattan Tratti Grigi Mosaico



# BLACK

+ TRATTI GRIGI  
MOSAICO





# JACOB'S BATHROOM

/ GREENWICH

**Wall**  
Manhattan Pearl  
Manhattan Grey  
Manhattan Tratti Grigi Mosaico

**Floor**  
Docks Cenere



# PEARL & GREY

• TRATTI GRIGI  
MOSAICO









# EMILY & SEBASTIAN'S BATHROOM

/ MIDTOWN EAST



**Wall**  
Manhattan Jeans  
Manhattan White Alzata

**Floor**  
Docks Neutro



# JEANS

- WHITE LONDON
- WHITE ALZATA





# ISABEL & ALEX'S BATHROOM

/ LOWER EAST SIDE



**Wall**  
Manhattan Smoke  
Meltin Cemento  
Meltin Vulcano Mosaico

**Floor**  
Terra Antracite





**SMOKE +  
MOSAICO +  
MELTIN  
GREY**





# SHOP

/ EAST  
VILLAGE



Wall  
Manhattan Beige  
Manhattan Sand  
Manhattan Vintage

Floor  
Docks Naturale



# VINTAGE SAND BEIGE







# BISTROT

/ UPPER EAST SIDE

Wall  
Manhattan Vintage  
Floor  
Docks Tabacco



VINTAGE





# BARBARA'S BATHROOM

/ CENTRAL  
PARK



**Wall**  
Manhattan Beige  
Manhattan Sand  
Manhattan Soho

**Floor**  
Docks Naturale



# BEIGE & SAND

- SOHO BEIGE  
LISTELLO
- SOHO BEIGE  
TOZZETTO





**SOHO BEIGE  
INSERTO:  
LIFESTYLE  
REALLY  
UPPER CLASS**





# KATHRINE & TOM'S BATHROOM

/ SOHO



**Wall**  
Manhattan Black  
Manhattan White  
Manhattan Soho Metal

**Floor**  
Docks Neutro



# BLACK & WHITE

- ✦ BLACK LONDON
- ✦ SOHO METAL LISTELLO
- ✦ WHITE LONDON
- ✦ WHITE ALZATA







**BLACK  
& WHITE:  
FOREVER  
BEAUTIFUL,  
LIKE  
MANHATTAN**





# MANHATTAN

## ONE STOP / ONE STYLE



Wall  
Manhattan Grey  
Manhattan Pearl  
Manhattan Smoke





**Wall A**  
 Manhattan Pearl 10x30  
 Manhattan Grey Spigolo 1x10  
 Manhattan Grey 10x30

**Wall C**  
 Manhattan Grey 10x30  
 Manhattan Pearl 10x30  
 Manhattan Grey Spigolo 1x10

**Wall B**  
 Manhattan Grey 10x30

**Floor**  
 Manhattan Tratti Grigi Mosaico 30x30  
 Docks Cenere 25x150 RT

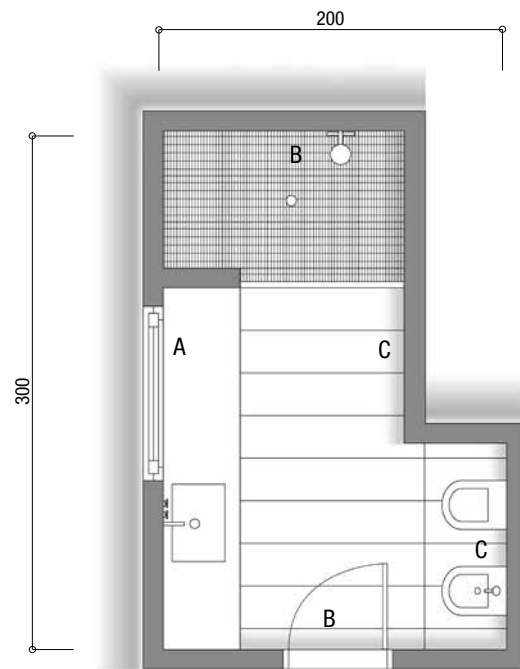

**Wall A**  
 Manhattan Jeans 10x30  
 Manhattan White London 5x30  
 Manhattan White Alzata 12,5x30  
 Manhattan White Raccordo 1x10  
 Manhattan White A.I. Alzata 1x12,5  
 Manhattan White A.I. London 1x5  
 Manhattan White A.E. London 1x5  
 Manhattan Jeans Spigolo 1x10

**Floor**  
 Docks Neutro 25x150 RT

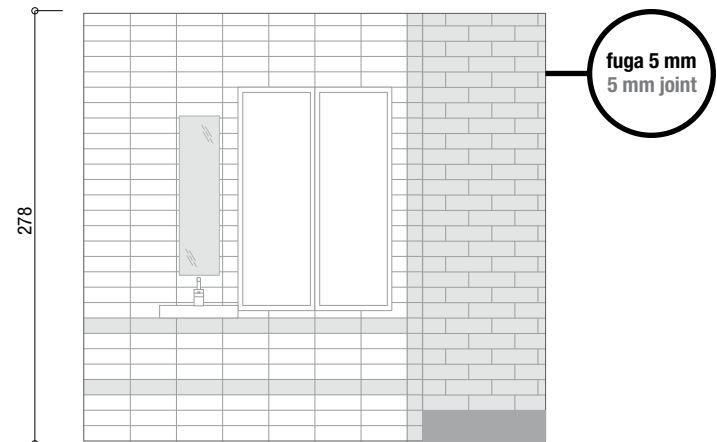
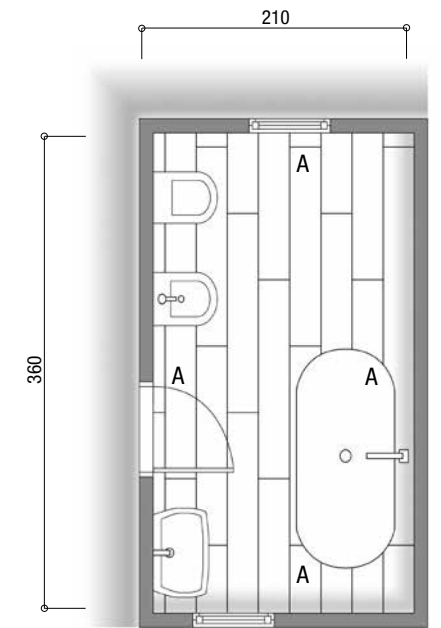

Wall A

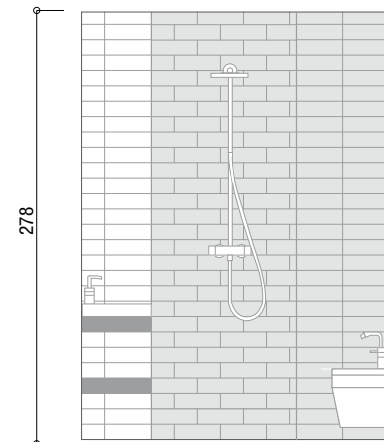

Wall B

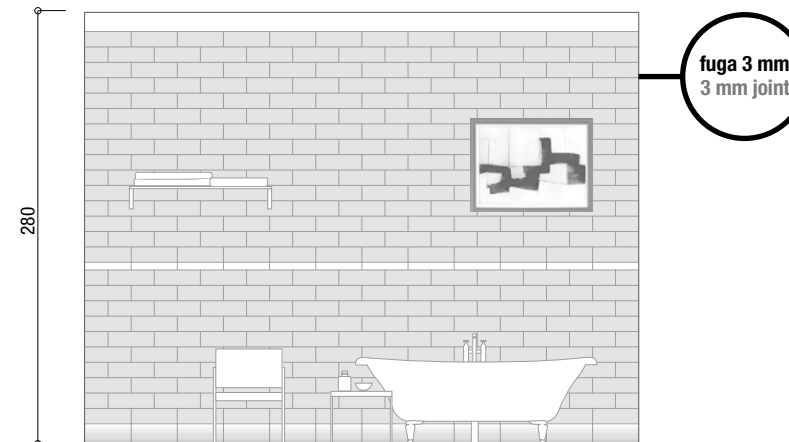

Wall A

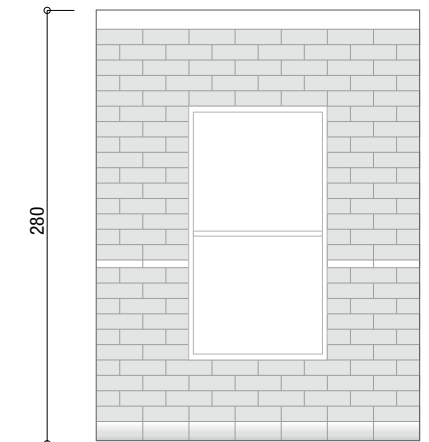

Wall A

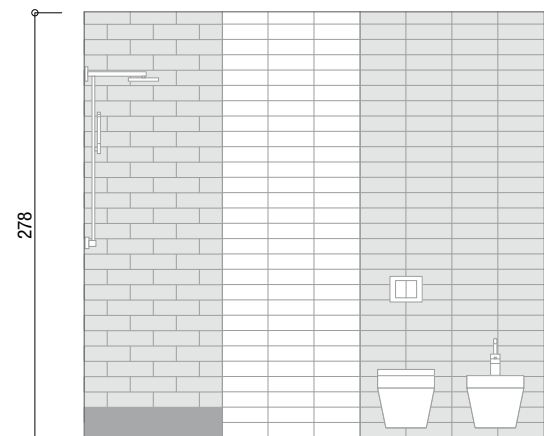

Wall C

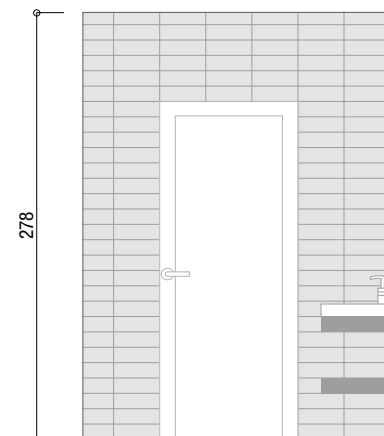

Wall B

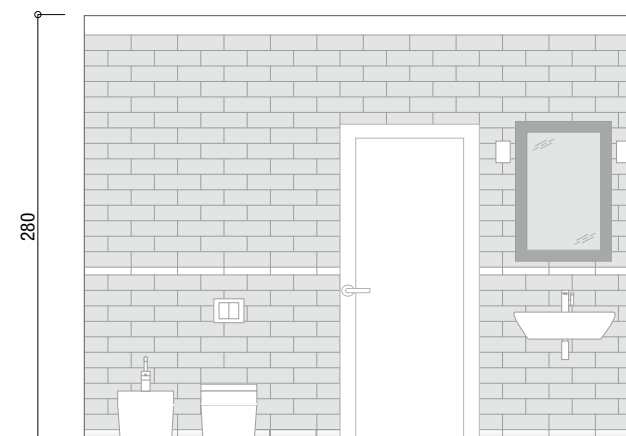

Wall A

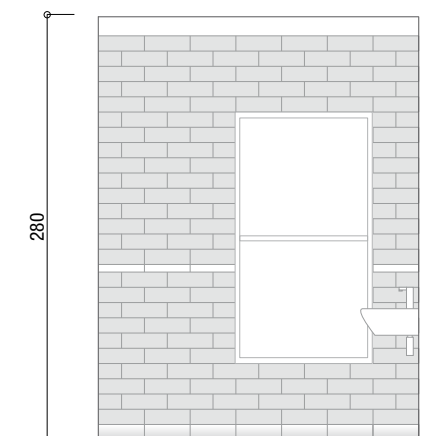

Wall A



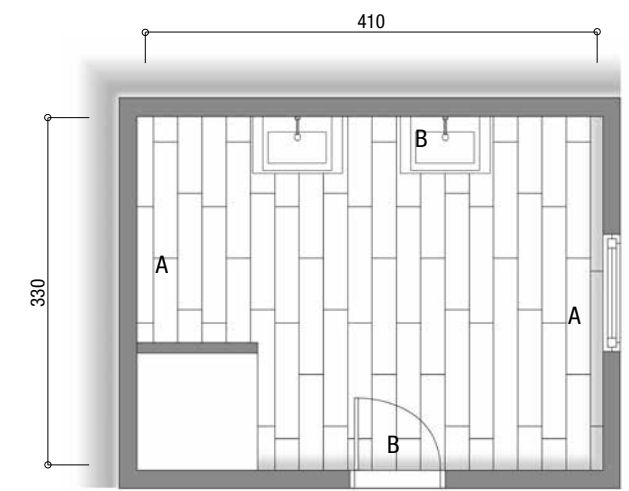
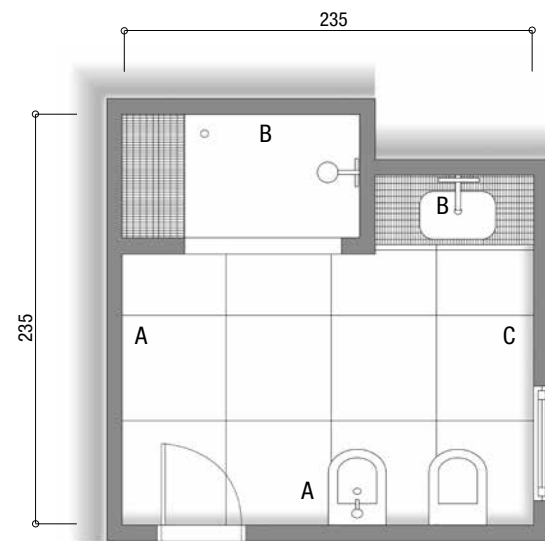

- Wall A**  
Manhattan Smoke 10x30
- Wall B**  
Manhattan Smoke 10x30  
Meltin Cemento 30,5x91,5 RT  
Meltin Cemento Spigolo 1x30,5 RT  
Meltin Vulcano Mosaico 30,5x30,5  
Meltin Terra Spigolo 1x30,5 RT
- Wall C**  
Meltin Cemento 30,5x91,5 RT
- Floor**  
Terra Antracite 60x60 RT

- Wall A**  
Manhattan Beige 10x30  
Manhattan Sand 10x30  
Manhattan Soho Beige Tozzetto 10x10  
Manhattan Soho Beige Listello 10x30  
Manhattan Soho Beige Inserto 30x30  
Manhattan Beige Spigolo 1x10
- Wall B**  
Manhattan Beige 10x30  
Manhattan Sand 10x30  
Manhattan Soho Beige Tozzetto 10x10  
Manhattan Soho Beige Listello 10x30  
Manhattan Soho Beige Inserto 30x30
- Floor**  
Docks Naturale 22,5x90 RT

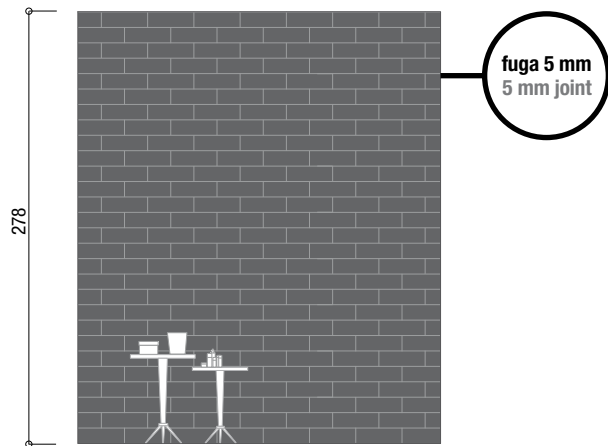

Wall A

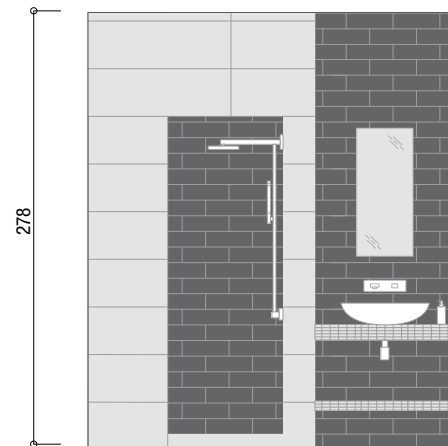

Wall B

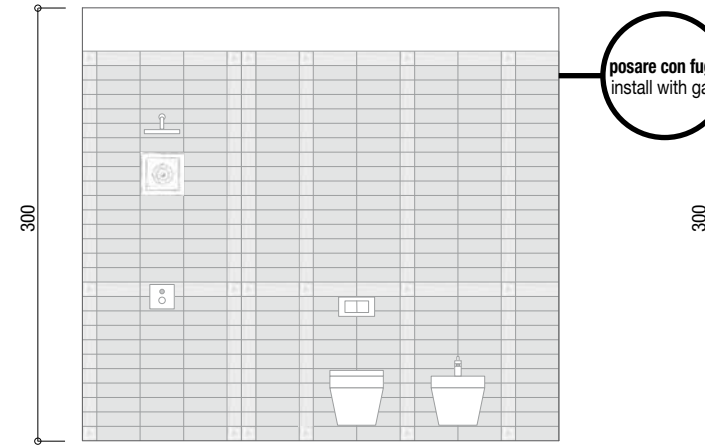

Wall A

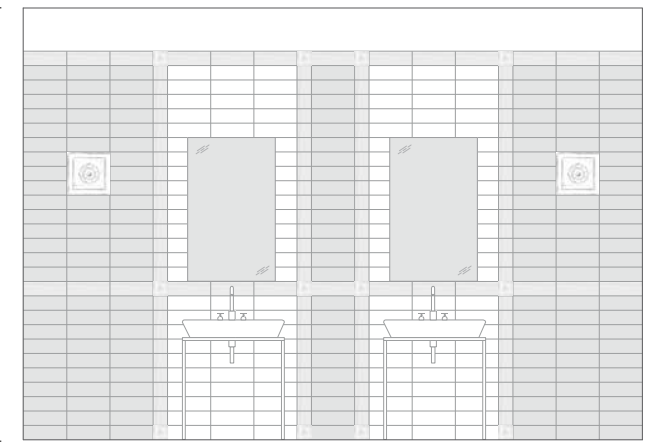

Wall B

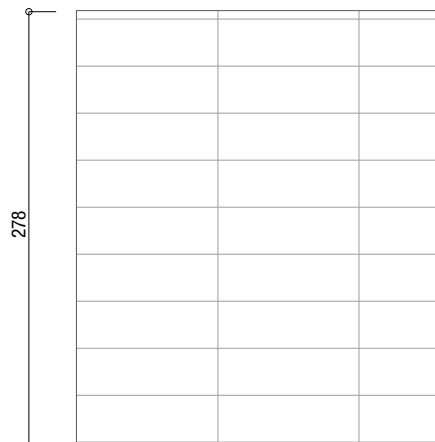

Wall C

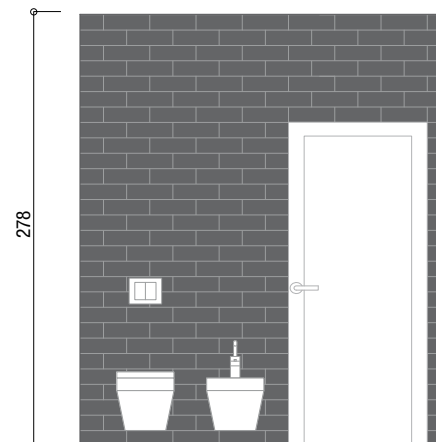

Wall B

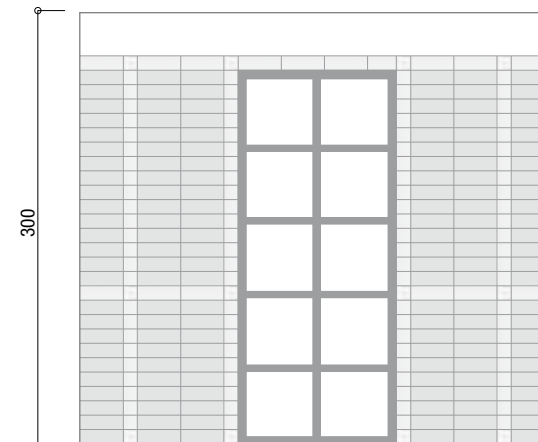

Wall A

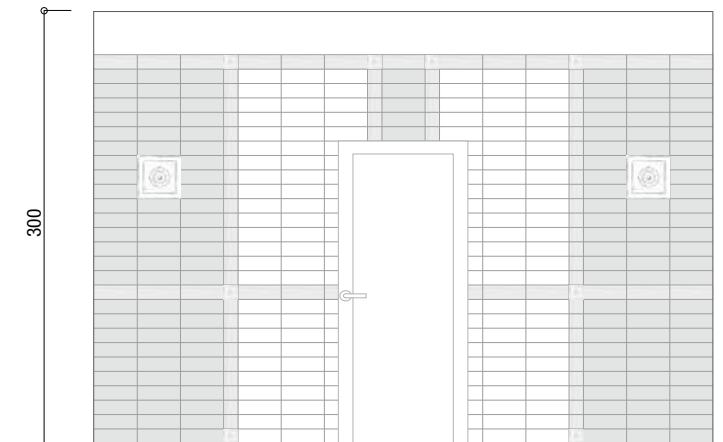

Wall B





**Wall A**

- Manhattan Black 10x30
- Manhattan Black London 5x30
- Manhattan Soho Metal Listello 10x30
- Manhattan White A.I. London 1x5
- Manhattan Black A.I. London 1x5
- Manhattan White A.E. London 1x5
- Manhattan Black A.E. London 1x5
- Manhattan Black Spigolo 1x10
- Manhattan White London 5x30

- Manhattan White Spigolo 1x10
- Manhattan White 10x30
- Manhattan White Alzata 12,5x30
- Manhattan White Raccordo 1x10
- Manhattan White A.I. Alzata 1x12,5
- Manhattan White A.E. Alzata 1x12,5

**FLOOR**  
Docks Neutro 25x150 RT

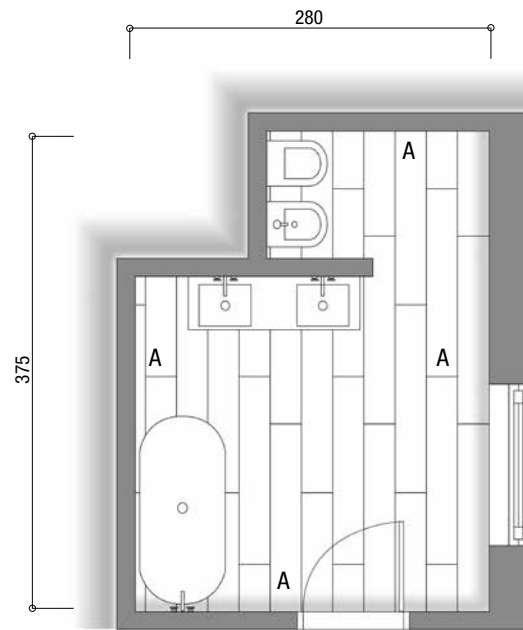

**Wall A**

- Manhattan Beige 10x30
- Manhattan Sand 10x30
- Manhattan Vintage 10x30

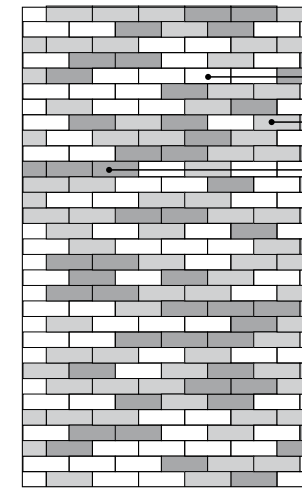

Wall A

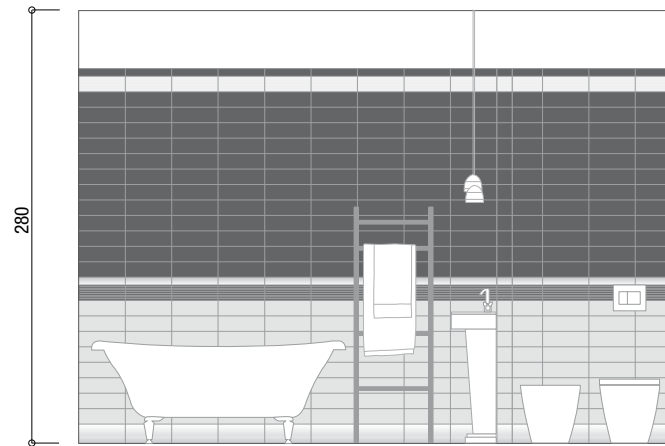

Wall A

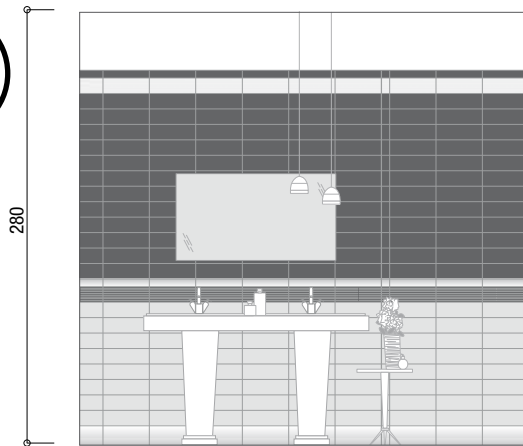

Wall A

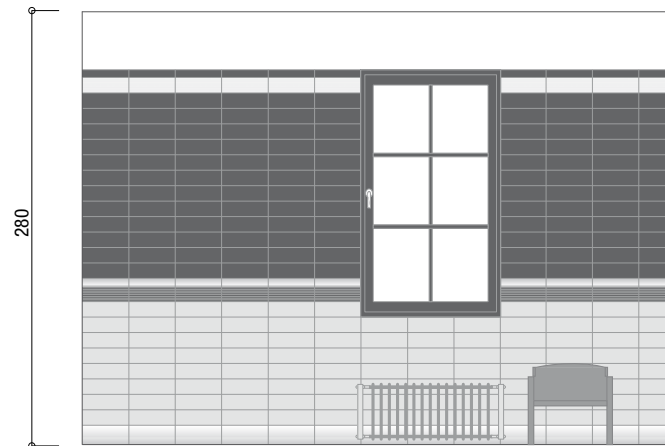

Wall A



Wall A



**Wall A**

- Manhattan Grey 10x30
- Manhattan Pearl 10x30
- Manhattan Smoke 10x30



Wall A





Manhattan Grey V1



Manhattan Smoke V1



Manhattan Pearl V1



Manhattan Vintage V1

BRILLANTE

10x30

BRILLANTE

10x30

BRILLANTE

10x30

BRILLANTE

10x30



Manhattan Black V1



Manhattan White V1



Manhattan Sand V1



Manhattan Beige V1

BRILLANTE

10x30

BRILLANTE

10x30

BRILLANTE

10x30

BRILLANTE

10x30



Manhattan Jeans V1

BRILLANTE

10x30

## MOSAICO



Manhattan Tratti Grigi  
Mosaico\* 30x30



Manhattan Tratti Terre  
Mosaico\* 30x30



Meltin Vulcano  
Mosaico\*\* 30,5x30,5



10 x 1,7 cm



2,8 x 2,8 cm

Manhattan Black  
Spigolo 1x10

2

◆ A.E. Spigolo  
1x1

3

Manhattan Grey  
Spigolo 1x10

2

◆ A.E. Spigolo  
1x1

3

Manhattan White  
Spigolo 1x10

2

◆ A.E. Spigolo  
1x1

3

Manhattan Smoke  
Spigolo 1x10

2

◆ A.E. Spigolo  
1x1

3

Manhattan Sand  
Spigolo 1x10

2

◆ A.E. Spigolo  
1x1

3

Manhattan Pearl  
Spigolo 1x10

2

◆ A.E. Spigolo  
1x1

3

Manhattan Beige  
Spigolo 1x10

2

◆ A.E. Spigolo 1x1

3

Manhattan Vintage  
Spigolo 1x10

2

◆ A.E. Spigolo  
1x1

3

Manhattan Jeans  
Spigolo 1x10

2

◆ A.E. Spigolo  
1x1

3

Manhattan Black  
London 5x30

2

◆ A.E. London  
1x5

3

◆ A.I. London  
1x5

3

Manhattan White  
London 5x30

2

◆ A.E. London  
1x5

3

◆ A.I. London  
1x5

3

Manhattan Sand  
London 5x30

2

◆ A.E. London  
1x5

3

◆ A.I. London  
1x5

3



Manhattan Soho Beige  
Inserto 30x30

6



Manhattan Soho Beige  
Listello 10x30

2



Manhattan Soho Beige  
Tozzetto 10x10

2



Manhattan Soho Metal  
Listello 10x30

2



Manhattan Soho Metal  
Tozzetto 10x10

2

	Unità di vendita Sales unit	MQ./Box	PZ./Box	Kg/Box	Box/PL
1	1 Box	0,81	27	15,00	72
2	1 Box	-	5	-	-
3	1 Box	-	4	-	-
4	1 Box	0,54	6	10,20	84
5	1 Box	0,558	6	7,70	60
6	1 Box	-	1	2,19	-



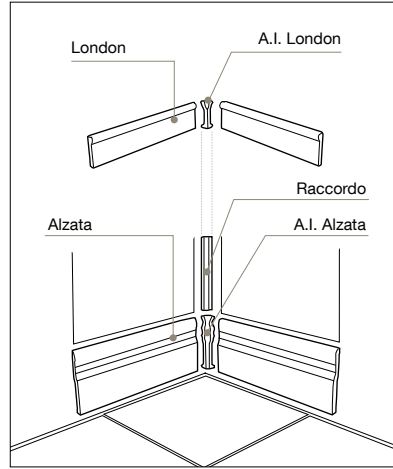
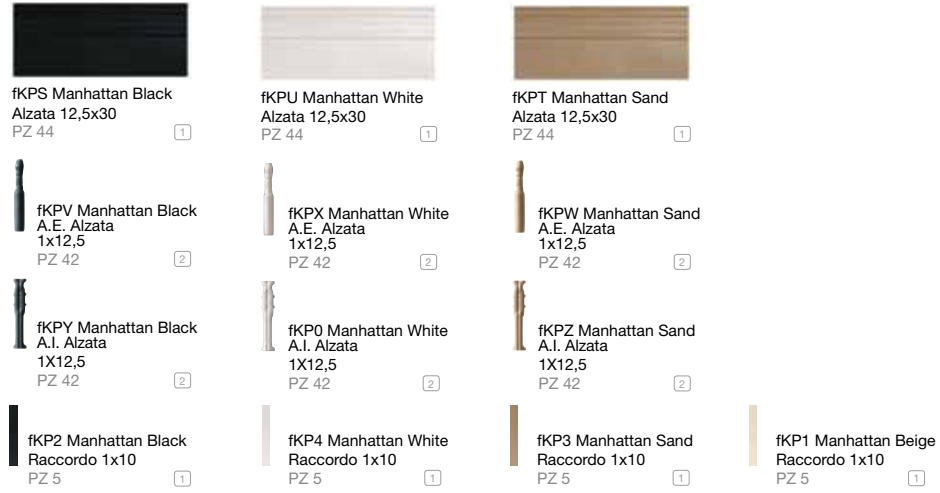

MANHATTAN	GREY	SMOKE	PEARL	VINTAGE	JEANS	BLACK	WHITE	SAND	BEIGE
10x30 4"x12"									
<b>BARK</b>	NEBBIA	-	-	-	-	-	ARTICO	-	AVANA
<b>DOCKS</b>	GENERE	GENERE	NEUTRO	TABACCO	NEUTRO	GENERE	NEUTRO	NATURALE	NEUTRO
<b>NUANCES</b>	QUERCIA	QUERCIA	QUERCIA	NOCE	QUERCIA	QUERCIA	FAGGIO	FAGGIO	FAGGIO
<b>TERRA</b>	MALTA	ANTRACITE	MALTA	-	-	ANTRACITE	AVORIO	SIENA	AVORIO

UTILIZZARE STUCCHI IN TINTA / USE MATCHING GROUTS

	Unità di vendita Sales unit	MQ./Box	PZ./Box	Kg/Box	Box/PL
[1]	1 Box	-	5	-	-
[2]	1 Box	-	4	-	-



## Suggerimenti di posa

Installation tips - Conseils de pose - Empfehlungen und Verlegealternativen - Sugerencias de colocacion - Рекомендации по укладке

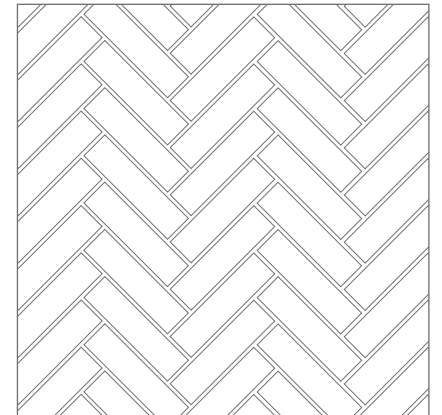
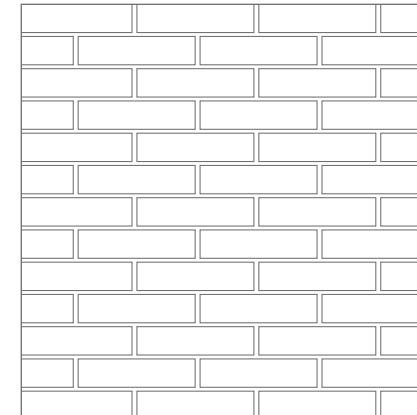

Fuga 3-5 mm / 3-5 mm gap / Joint 3-5 mm / Junta 3-5 mm / швом 3-5 mm



# Informazioni utili

Useful information. / Informations utiles. / Nützliche Informationen. / Información útil. / Полезная информация.



## FAP È MADE IN ITALY

Tutte le piastrelle Fap ceramiche sono prodotte in Italia. Chi acquista ceramiche Fap ha la sicurezza che esse siano prodotte con tecnologie che rispettano l'ambiente, utilizzando materie prime eccellenti e sicure, garantendo le migliori condizioni di lavoro possibile.

## FAP IS MADE IN ITALY

All Fap ceramiche tiles are produced in Italy. Anyone purchasing Fap ceramics can be sure that they are produced using technologies that respect the environment, using safe, excellent raw materials, guaranteeing the best possible working conditions.

## FAP EST MADE IN ITALY

Toute la production de carreaux Fap ceramiche est réalisée en Italie. Acheter un produit Fap c'est avoir la certitude d'une technologie qui respecte l'environnement, de matières premières nobles et sûres et d'une attention particulière aux conditions de travail.

## FAP IST IN ITALIEN HERGESTELLT

Alle Fliesen von Fap ceramiche werden in Italien erzeugt. Durch den Kauf von Keramikprodukten von Fap erhält man die Sicherheit, dass sie mit umweltfreundlichen Technologien unter Einsatz von ausgezeichneten, sicheren Rohstoffen produziert wurden, wobei die bestmöglichen Arbeitsbedingungen gewährleistet werden.

## FAP - ЭТО MADE IN ITALY

Вся керамическая плитка от компании Fap ceramiche производится в Италии. Тот, кто выбирает плитку Fap, может быть уверен, что при её изготовлении применяются природосберегающие технологии и используется высококачественное и надежное сырьё при обеспечении наилучших условий труда



Fap ceramiche aderisce al Codice Etico di Confindustria Ceramica, che impegna le aziende a comunicare con chiarezza l'origine dei propri prodotti. Il marchio Ceramics of Italy può essere utilizzato esclusivamente per contrassegnare i prodotti ceramici realizzati in Italia.

Fap ceramiche follows the Confindustria Ceramica Code of Ethics, which commits businesses to clearly informing of the origin of their products. The Ceramics of Italy trade mark can be used exclusively on ceramic products made in Italy.

Fap ceramiche adhère au Code d'Ethique de Confindustria Ceramica qui impose aux entreprises de communiquer clairement l'origine de ses produits. Le label Ceramics of Italy ne peut être utilisé que pour des carreaux céramique intégralement fabriqués en Italie.

Fap ceramiche hält sich an den Ehrenkodex von Confindustria Ceramica, der die Firmen verpflichtet, den Ursprung der eigenen Produkte klar mitzuteilen. Das Markenzeichen Ceramics of Italy darf ausschließlich für die Kennzeichnung von in Italien erzeugten Keramikprodukten verwendet werden.

Компания Fap ceramiche присоединяется к Этическому Кодексу Confindustria Ceramica (Объединение предпринимателей керамической промышленности), согласно которому предприятия обязаны чётко указывать происхождение собственной продукции. Марка Ceramics of Italy может быть использована исключительно на товарах, произведенных в Италии.



Fap ceramiche è membro dell'U.S. Green Building Council, organizzazione USA volta a favorire e accelerare la diffusione di una cultura dell'edilizia sostenibile.

Fap ceramiche is a member of the U.S. Green Building Council, the US organisation that seeks to promote and spread a sustainable building culture.

Fap ceramiche est membre de l'U.S. Green Building Council, organisation américaine visant à favoriser et accélérer la diffusion d'une culture de la construction durable.

Fap ceramiche ist Mitglied des U.S. Green Building Council, eine gemeinnützige Organisation mit Sitz in den USA, welche sich für nachhaltiges Bauen einsetzt und ein entsprechendes Bewusstsein schaffen will.

Компания Fap ceramiche является членом U.S. Green Building Council, американской организации, деятельность которой направлена на внедрение и широкое распространение культуры экологического строительства.

Fap ceramiche ha realizzato la ENVIRONMENTAL PRODUCT DECLARATION (EPD), certificata da un organismo terzo indipendente. L'EPD rappresenta una sorta di carta di identità dei prodotti, ne descrive l'impatto sull'ambiente dalla fase di estrazione delle materie prime alla commercializzazione e durante l'intero ciclo di vita fino allo smaltimento.

Fap ceramiche has created the ENVIRONMENTAL PRODUCT DECLARATION (EPD), which has been certified by an independent body. The EPD is a sort of identity card for products, which describes their impact on the environment, from the extraction of the raw materials through to sale and on through their entire life cycle until disposal.

Fap ceramiche a réalisé l'ENVIRONMENTAL PRODUCT DECLARATION (EPD) qui a été certifiée par un organisme indépendant. L'EPD représente une sorte de carte d'identité des produits et en décrit l'impact sur l'environnement depuis la phase d'extraction des matières premières à la commercialisation, et cela pendant la totalité du cycle de durée de vie jusqu'à l'élimination.

Fap ceramiche hat die ENVIRONMENTAL PRODUCT DECLARATION (EPD) erhalten, diese Umweltproduktdeklaration wurde von einer unabhängigen Zertifizierungsstelle erstellt. Die EPD ist eine Art Ausweis für die Produkte und beschreibt die Auswirkungen auf die Umwelt eines Produkts von der Gewinnung der Rohstoffe für die Herstellung und der Vermarktung über den gesamten Lebenszyklus bis hin zur Entsorgung.

Продукция компании Fap прошла проверку независимой организации, в результате чего получила сертификат ENVIRONMENTAL PRODUCT DECLARATION (EPD). EPD — это своего рода паспорт продукции, где приводятся данные о влиянии производства на окружающую среду начиная с добычи сырья и заканчивая реализацией продукции. В документе приводится описание полного цикла жизни товаров вплоть до их утилизации.

Fap ceramiche è tra le prime aziende del settore ceramico ad aver realizzato la PRODUCT ENVIRONMENTAL FOOTPRINT (PEF), strumento di dichiarazione ambientale promosso dalla UE. La PEF di Fap ceramiche è certificata da un ente terzo indipendente.

Fap ceramiche is one of the first companies in the ceramic sector to have created the PRODUCT ENVIRONMENTAL FOOTPRINT (PEF), an environmental declaration tool promoted by the EU. Fap ceramiche's PEF is certified by an independent body.

Fap ceramiche figure parmi les premières entreprises du secteur céramique à avoir réalisé la PRODUCT ENVIRONMENTAL FOOTPRINT (PEF), instrument de déclaration environnementale promu par l'UE. La PEF de Fap ceramiche est certifiée par un organisme tiers indépendant.

Fap ceramiche gehört zu den ersten Unternehmen in der Keramikbranche, die eine Bewertung nach dem PRODUCT ENVIRONMENTAL FOOTPRINT (PEF) erhalten haben, der Umweltfußabdruck von Produkten ist eine Umwelterklärung der EU. Die PEF von Fap ceramiche wurde von einer unabhängigen Stelle zertifiziert.

Fap ceramiche стала одной из первых компаний в керамическом секторе, получившей сертификат PRODUCT ENVIRONMENTAL FOOTPRINT (PEF). PEF оценивает по стандартам ЕС воздействие производства на окружающую среду. Сертификат PEF был выдан Fap ceramiche независимой организацией.







## Monocottura - Standard EN 14411 (ISO 13006) Annex H Group B1b, 0,5 < E ≤ 3%

Single Fired / Monocuisson / Einbrandverfahren / Monococcion / одинарного обжига.

CARATTERISTICHE TECNICHE TECHNICAL SPECIFICATIONS CARACTERISTIQUES TECHNIQUES TECHNISCHE EIGENSCHAFTEN CARACTERÍSTICAS TÉCNICAS ТЕХНИЧЕСКИЕ ХАРАКТЕРИСТИКИ		NORME STANDARDS NORMES NORMEN NORMAS НОРМЫ	VALORE PRESCRITTO VALUES REQUIRED VALEUR PRESCRITE NORMVORGABE VALOR PRESCRITO ЗАДАННОЕ ЗНАЧЕНИЕ EN 14411 - ISO 13006 B1b	MANHATTAN FAP - VALORE MEDIO• AVERAGE RATING VALEUR MOYENNE DURCHSCHNITTSWERT VALOR MEDIO СРЕДНЕЕ ЗНАЧЕНИЕ B1b		
			NON RETTIFICATO - NOT RECTIFIED	RETTIFICATO - RECTIFIED	10x30	
DIMENSIONI SIZES DIMENSIONS GRÖSSEN DIMENSIONES РАЗМЕРЫ		<b>Lunghezza e larghezza</b> Length and width / Dimensions des côtés / Seitenlänge / Largo y ancho / Длина и ширина	± 0,6%, max 2 mm	± 0,3%, max 1 mm	Conforme In accordance	
		<b>Spessore</b> Thickness / Épaisseur / Stärke / Espesor / Толщина	± 5%, max 0,5 mm	± 5%, max 0,5 mm	Conforme In accordance	
		<b>Ortogonalità **</b> Wedging / Orthogonalité / Rechtwinkligkeit / Ortogonalidad / Ортогональность	± 0,5%, max 2 mm	± 0,3%, max 1,5 mm	Conforme In accordance	
		<b>Rettilineità degli spigoli</b> Straightness of the edges / Equerrage des angles / Kantengeradheit / Rectilinearidad de las aristas / Прямолинейность углов	± 0,5%, max 1,5 mm	± 0,3%, max 0,8 mm	Conforme In accordance	
		<b>Planarità</b> Flatness / Planéité / Oberflächenqualität / Planicidad / Плоскостность	± 0,5%, max 2 mm	± 0,4%, max 1,8 mm	Conforme In accordance	
STRUTTURA STRUCTURE STRUCTURE STRUKTUR ESTRUCTURA СТРУКТУРА		<b>Sforzo di rottura</b> Breaking strength / Force de rupture / Bruchlast / Esfuerzo de ruptura / Усилие на излом	S ≥ 1100 N		S ≥ 2000 N	
		<b>Resistenza alla flessione</b> Bending strength / Résistance à la flexion / Biegefestigkeit / Resistencia a la flexión / Прочность при изгибе	ISO 10545-4	R ≥ 30 N/mm <sup>2</sup>		Conforme In accordance
		<b>PEI</b>	ISO 10545-7	<b>Abrasion Class and Cycled Passed</b>	Beige, Pearl e White: 5 Grey, Jeans, Sand e Smoke: 3 Vintage: 2 Black: 1	
SBALZI TERMICI THERMAL SHOCK ECARTS DE TEMPERATURE TEMPERATURWECHSEL CHOQUES TÉRMICOS ТЕМПЕРАТУРНЫЕ ПЕРЕПАДЫ		<b>Coefficiente di dilatazione termica lineare</b> Coefficient of thermal linear expansion / Coefficient de dilatation thermique linear / Wärmeausdehnungskoeffizient / Coeficiente de dilatación termica linear / Коэффициент теплового линейного расширения	ISO 10545-8	<b>Metodo di prova disponibile / Valore dichiarato / Declared value / Test method available / Méthode d'essai disponible / Verfügbare Prüfmethode / Método de prueba disponible / Доступный метод испытания</b>	≤ 7 МК <sup>-1</sup>	
		<b>Resistenza agli sbalzi termici</b> Thermal shock resistance / Resistance aux variations thermiques / Temperaturwechselbeständigkeit / Resistencia a las diferencias de temperatura / Сопротивление температурным перепадам	ISO 10545-9	<b>Resistente</b> Resistant		Resistente Resistant
		<b>Resistenza al gelo</b> Resistance to frost / Résistance au gel / Frostbeständigkeit / Resistencia al hielo / Морозостойчивость	ISO 10545-12	<b>Resistente</b> Resistant		Resistente Resistant
RESISTENZA CHIMICA CHEMICAL RESISTANCE RÉSISTANCE AUX ATTAQUES CHIMIQUES CHEMIKALIENFESTIGKEIT RESISTENCIA A LOS PRODUCTOS QUÍMICOS ХИМИЧЕСКАЯ СТОЙКОСТЬ		<b>Resistenza ai prodotti chimici di uso domestico e agli additivi per piscina</b> Resistance to household chemicals and swimming pool salts / Résistance aux produits chimiques à usage domestique et aux adjuvants pour piscines / Beständigkeit gegen Haushaltchemikalien und Badwasserzusätze / Resistencia a los productos químicos de uso domestico o productos para la piscina / Сопротивляемость химическим средствам домашнего применения и добавкам для бассейна.	ISO 10545-13	GB Min.	Conforme In accordance	
		<b>Resistenza a basse concentrazioni di acidi ed alcali</b> Resistance to low concentrations of acids and alkalis / Résistance aux acides et aux alcalis à basse concentration / Beständigkeit gegen niedrigkonzentrierte Säuren und Laugen / Resistencia a concentración baja de ácidos y álcali / Сопротивляемость кислотам и щелочам низкой концентрации		<b>Secondo la classificazione indicata dal fabbricante.</b> According to classification indicated by the manufacturer / Selon la classification indiquée par le fabricant / Je nach der angegebenen Fabrikantenbewertung / Según la clasificación indicada del fabricante / Согласно классификации, указанной производителем.		GLB Min.
		<b>Resistenza alle macchie</b> Stain resistance / Résistance aux taches / Baständigkeit gegen Fleckenbildung / Resistencia a las manchas / Стойкость к загрязнению	ISO 10545-14	<b>Metodo di prova disponibile / Valore dichiarato / Declared value / Test method available / Méthode d'essai disponible / Verfügbare Prüfmethode / Método de prueba disponible / Доступный метод испытания</b>		5

La classificazione V-Shade indica il livello di stonizzazione del prodotto, classificato da V0 a V4.

The V-Shade classification indicates the level of shading of the product, ranked from V0 to V4.

### V0

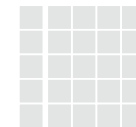

Nessuna  
None  
Aucune  
Keine  
Ninguna  
нулевой

### V1

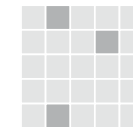

Leggera  
Light  
Légère  
Leicht  
Ligera  
Низкий

### V2

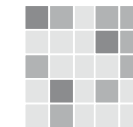

Moderata  
Moderate  
Modérée  
Mäßig  
Moderada  
Средний

### V3

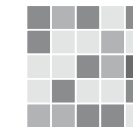

Alta  
High  
Élevée  
Hoch  
Alta  
Значительный

### V4

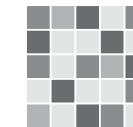

Forte  
Very High  
Forte  
Stark  
Fuerte  
Высокий

Le classement V-shade indique le niveau de mouvement chromatique au sein d'un produit. Il va de V0 à V4.

Die V-Shade-Einstufung zeigt das Abtönungsniveau des Produkts an, das zwischen V0 und V4 eingestuft wird.

La clasificación V-Shade indica el nivel de destonización del producto, clasificado de V0 a V4.

Согласно классификации V-Shade, указывающей на уровень цветовой неоднородности изделия, нашей плитке были присвоены значения от V0 до V4.

I colori e le caratteristiche estetiche dei materiali illustrati nel presente catalogo sono da ritenersi puramente indicativi.

Colours and optical features of the materials illustrated in this catalogue are to be regarded as mere indications.

Die Farben und die ästhetischen Eigenschaften der in diesem Katalog abgebildeten Produkte sind als reine Richtwerte zu betrachten.

Les couleurs et les caractéristiques esthétiques des références illustrées dans le catalogue sont données à titre purement indicatif.

Los colores y las características ópticas de los materiales ilustrados en este catálogo deben ser mirados como indicaciones meras.

Цвета и эстетические характеристики описанных в настоящем каталоге материалов являются только ориентировочными.

Fap ceramiche si riserva di apportare modifiche e/o eliminare senza preavviso i prodotti declinando ogni responsabilità per danni diretti o indiretti derivanti da eventuali modifiche.

Fap ceramiche can change the indicated products without notice declining any responsibility for direct or indirect damage that depend on these changes.

Fap ceramiche se réserve le droit de modifier sans préavis les produits indiqués et décline toute responsabilité pour dommages directs ou indirects dus à éventuelles modifications.

Fap Ceramiche se reserva la facultad de modificar los productos sin preaviso, declinando cualquier responsabilidad por daños directos o indirectos que dependan de estos cambios.

Fap ceramiche kann die genannten Produkten ändern ohne Voranmeldung und lehnt dabei jegliche Verantwortung für die davon abhängenden direkten oder indirekten Schäden ab.

Компания "Fap ceramiche" сохраняет за собой право на внесение изменений в продукцию без предварительного уведомления, снимая с себя всякую ответственность за связанный с этими изменениями прямой или косвенный ущерб.

• Valore medio dei test condotti negli ultimi 24 mesi. Average rating of tests conducted during the last 24 months. Durchschnittswert der in den letzten 24 Monaten durchgeführten Tests. Valeur moyenne des essais menés au cours des 24 derniers mois. Valor medio de las pruebas llevadas a cabo en los últimos 24 meses. Среднее значение испытаний, проведенных в течение последних 24 месяцев.

•• Per piastrelle rettangolari, che abbiano il lato maggiore L ≥ 60 cm, e rapporto tra i lati ≥ 3, la misurazione della ortogonalità deve venire condotta solo sul lato corto. For oblong tiles with L ≥ 60 cm and ratio length/width L/W ≥ 3, measurement of rectangularity only on short edges



Fap ceramiche - 4<sup>th</sup> edition, september 2017, 1<sup>st</sup> edition september 2013

È vietata la riproduzione anche parziale dell'opera in tutte le sue forme.  
Reproduction of this printed catalogue, even partially, is prohibited.







**FAP**  
CERAMICHE  
Naturalmente casa.

**MOSCOW  
SHOWROOM**

Via Ghiarola Nuova, 44 - 41042 Fiorano Modenese (MO) Italy  
tel. +39 0536 837511 - fax +39 0536 837532 - fax estero +39 0536 837542  
[www.fapceramiche.com](http://www.fapceramiche.com) - [info@fapceramiche.com](mailto:info@fapceramiche.com)



Hamovnichevskiy Val, 36 - Moscow Metro / Sportivnaya tel. +7 (495) 775 05 20  
[www.fapceramiche.ru](http://www.fapceramiche.ru) - [moscow@fapceramiche.com](mailto:moscow@fapceramiche.com)